

Teleskopzylinder

ATTACCO AD OCCHIO
EYE-FITTING

ATTACCO A SFERA
BALL-FITTING

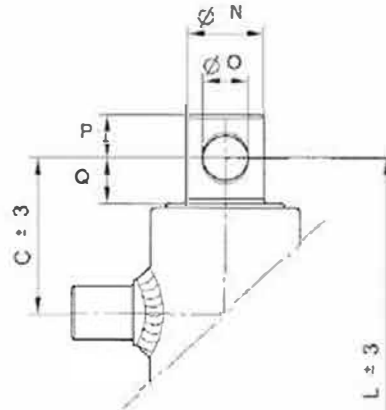

Portata a 100 bar/ton
Charge a 100 bar/ton
Capacity at 100 bar/ton
Bajastbarkoll 100
bar/ton
Capacidad 100 bar/ton

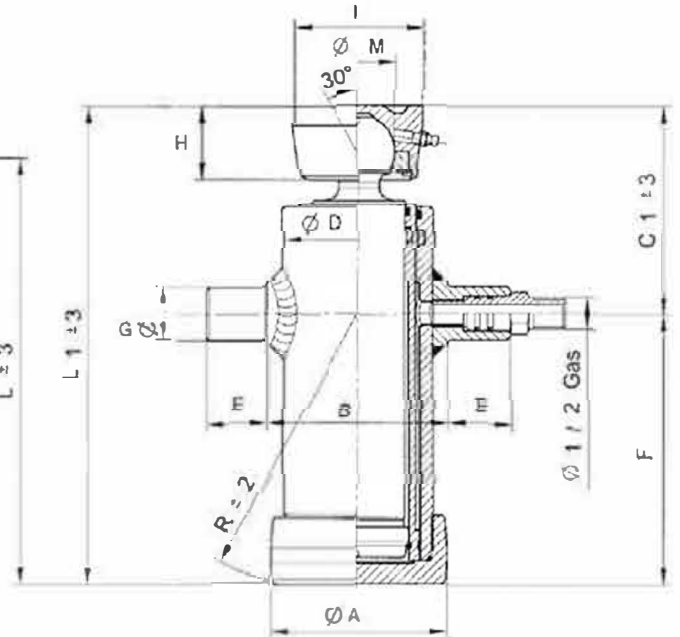

Art/ Ref.	A mm	B mm	C mm	D mm	E mm	F mm	G mm	H mm	I mm	N mm	O mm	L mm	M mm	P mm	Q mm	Tipo/Type	Sfilata/ Extension	Portata/Capacità/ Flow/Capacity	Capacità lt/ Capacity lt	Corsa/ Stroke
01411	110	115	105	93	40	310	35	-	-	59	31	415	-	30	25	FORO / HOLE	2	6	2.3	595
01412	110	115	105	93	40	360	35	-	-	59	31	465	-	30	25	FORO / HOLE	2	6	2.7	695
01403	130	134	105	112.5	40	220	35	-	-	59	31	325	-	30	25	FORO / HOLE	3	8	2.8	593
01419	130	134	105	112.5	40	250	35	-	-	59	31	355	-	30	25	FORO / HOLE	3	8	3.3	683
01420	130	134	110	112.5	40	280	35	-	-	59	31	390	-	30	25	FORO / HOLE	3	8	3.8	785
01421	130	134	110	112.5	40	315	35	-	-	59	31	425	-	30	25	FORO / HOLE	3	8	4.2	893
01422	130	134	110	112.5	40	365	35	-	-	59	31	475	-	30	25	FORO / HOLE	3	8	5	1043
01429	145	147	112	124	40	225	40	-	-	59	31	337	-	30	25	FORO / HOLE	4	10	5	830
01432	145	147	112	124	40	315	40	-	-	59	31	427	-	30	25	FORO / HOLE	4	10	7	1190
01433	145	147	112	124	40	340	40	-	-	59	31	452	-	30	32	FORO / HOLE	4	10	7.5	1290
01434	145	147	112	124	40	395	40	-	-	59	31	507	-	30	25	FORO / HOLE	4	10	8.8	1510
01446	172	172	120	150	45	313	45	-	-	59	31	433	-	30	25	FORO / HOLE	5	11	11	1480
01415	110	115	150	93	40	310	35	55	95	-	-	460	55	-	-	SFERA / BALL	2	6	2.3	595
01416	110	115	150	93	40	360	35	55	95	-	-	510	55	-	-	SFERA / BALL	2	6	2.7	695
01414	110	115	142	93	40	180	35	44	112	-	-	322	45	-	-	SFERA / BALL	3	5	1.6	500
01652	110	115	142	93	40	310	35	44	112	-	-	452	45	-	-	SFERA / BALL	3	5	2.8	893
01423	130	134	147	112.5	40	190	35	55	95	-	-	337	55	-	-	SFERA / BALL	3	8	2.5	500
01428	130	134	147	112.5	40	220	35	55	95	-	-	367	55	-	-	SFERA / BALL	3	8	2.8	593
01424	130	134	147	112.5	40	250	35	55	95	-	-	397	55	-	-	SFERA / BALL	3	8	3.3	683
01425	130	134	152	112.5	40	280	35	55	95	-	-	432	55	-	-	SFERA / BALL	3	8	3.8	785
01426	130	134	152	112.5	40	315	35	55	95	-	-	467	55	-	-	SFERA / BALL	3	8	4.2	893
01427	130	134	152	112.5	40	365	35	55	95	-	-	517	55	-	-	SFERA / BALL	3	8	5	1043
01655	145	147	150	124	40	155	40	44	112	-	-	305	45	-	-	SFERA / BALL	5	8	3.5	690
01437	145	147	156	124	40	225	40	55	95	-	-	381	55	-	-	SFERA / BALL	4	10	5	830
01653	145	147	156	124	40	280	40	55	95	-	-	436	55	-	-	SFERA / BALL	4	10	6.2	1050
01440	145	147	156	124	40	315	40	55	95	-	-	471	55	-	-	SFERA / BALL	4	10	7	1190
01441	145	147	156	124	40	340	40	55	95	-	-	496	55	-	-	SFERA / BALL	4	10	7.5	1290
01442	145	147	156	124	40	395	40	55	95	-	-	551	55	-	-	SFERA / BALL	4	10	8.8	1510
01656	145	147	150	124	40	185	40	44	112	-	-	335	45	-	-	SFERA / BALL	5	8	4.5	840
01657	172	172	165	150	45	213	45	55	95	-	-	378	55	-	-	SFERA / BALL	5	11	7.5	980
01445	172	172	165	150	45	313	45	55	95	-	-	478	55	-	-	SFERA / BALL	5	11	11	1480