

3.5 GALLON PARTS WASHER

WARNINGS

Read carefully before operating.

- Do not over fill solvent. fill to just below level of parts tray.
- Do not use any solvent with a flashpoint below 150° F.
- Only use petroleum or biodegradable based solvents that are approved for electric parts washers.
- Use only in a well ventilated area.
- Do not operate while smoking.
- Do not operate near heat sources such as heaters, sparks, open flame, etc.
- Should fire occur in parts washer do not attempt to move parts washer
Lid is on a fusible link and will fall automatically to extinguish flame.
- Do not modify or jam lid to keep lid locked in an open position.
- Replace damaged parts immediately.
- Use only on grounded 110V~120V, 60Hz, (220V~240V 50Hz), outlet.

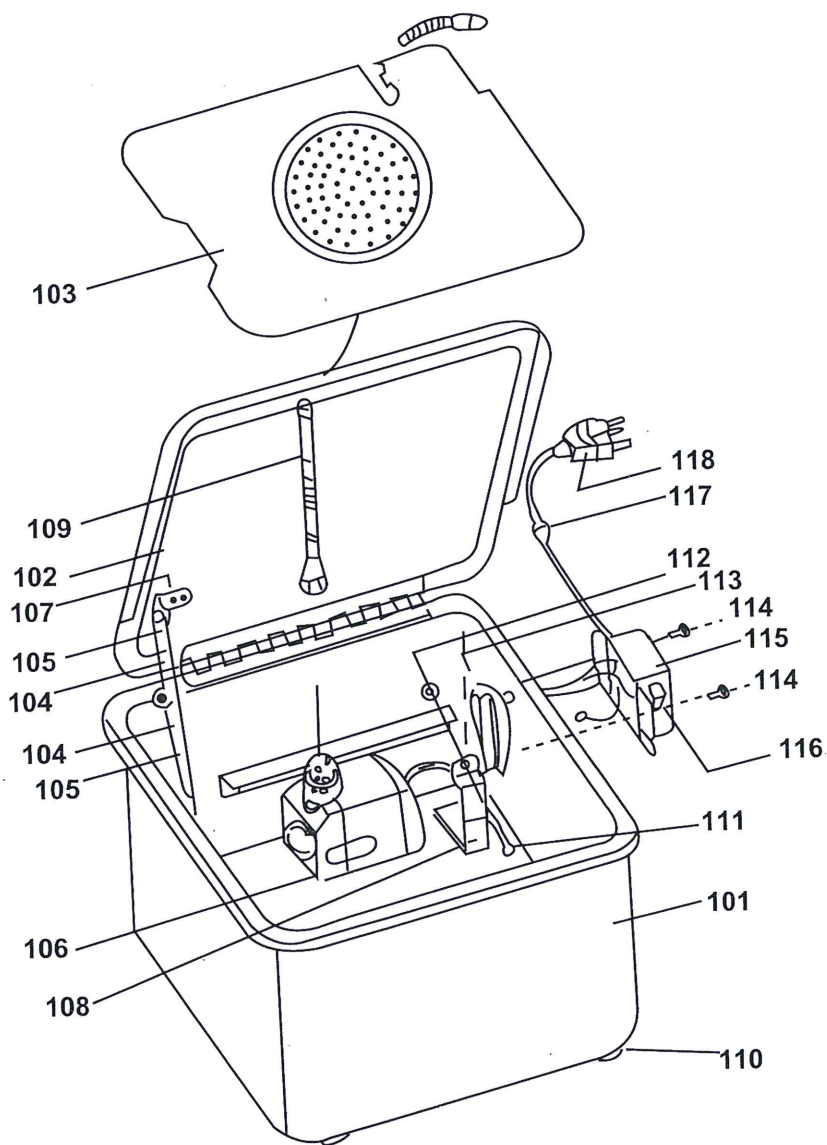

ITEM	QTY	DESCRIPTION	ITEM	QTY	DESCRIPTION
101	1	TANK	110	4	PLASTIC PLATE
102	1	LID	111	1	M5x30 SCREW
103	1	HEAVYDUTY REMOVABLE WORK SHELF	112	1	M5 NUT
104	2	FUSIBLE LINKED LID ARM	113	1	COVER
105	2	SAFETY PLATE	114	3	M4x12 SCREW
106	1	PUMP	115	1	HANDLE
107	5	RIVET	116	1	LIGHT SWITCH
108	1	PUMP HOLDER	117	1	STRAIN RELIEF
109	1	FLEXIBLE METAL SPIGOT	118	1	POWER CORD